

Datasheet

WWH05-510CT C-mount Megapixel Telecentric Lens

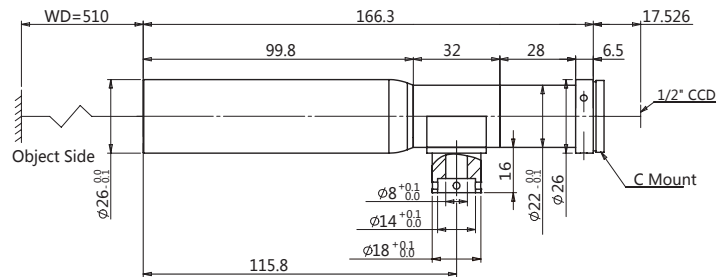

Features

- Compact design with coaxial light options
- Perfect image and supports all kinds of mega cameras
- Optional adjustable Iris for resolution and DOF control
- High contrast, low distortion, high resolution
- With optional long working distance, versions with over 500mm WD.

Optical Specifications

Magnification(x)	0.5
Working Distance(mm)	510±3
Max Sensor Size(Φmm)	8.0(1/2")
Best Aperture(f/#)	F14.2
MTF30(lp/mm)	≥ 60
Optical Distortion(%)	≤ 0.3
Telecentricity(deg)	-
NA	0.0174
Resolution(um)	19.3
Depth of Field(mm)	4.5

Mechanical Specifications

Mount	C
Length(mm)	166.3
Weight(kg)	-
Coaxial Light	Yes
Adjustable Iris	No

Field of View(mm x mm)

1/2" 9M001 with 6.66x5.33	13.32x10.66
1/2" ICX267/205 with 6.47x4.84	12.94x9.68