

Standard Resolution Telecentric lens --- WD 65mm

Maximally support
to 2/3" camera

Particularly suit for the
high precision image
positioning

Object telecentric
design & Standard
C-Mount

1. Support more than 450,000 pixels resolution, max support 2/3" camera.
2. WD 65mm
3. Object telecentric design, particularly suit for the high precision image positioning.
4. Standard C-Mount
5. Depth of focus is calculated by permissive circle radius of confusion $\sim 20\mu\text{m}$ on the image side, we can also provide customer DOF data at specific resolution and contrast requirements



Model	Coax.	Mag.	WD (mm)	Telecentricity (degree)	Distortion (%)	DOF (mm)	Resolution (μm)	Mount (17.528mm)	FOV for different Sensor size (mm.x mm)		
									1/3inch 4.8x3.6	1/2inch 6.4x4.8	2/3inch 8.8x6.6
XF-T0.5X65D	Y	0.5X	65	0.07	0.01	7	22	C-Mount	9.6x7.2	12.8x9.6	17.6x13.2
XF-T0.5X65	N	0.5X	65	0.07	0.01	7	22	C-Mount	9.6x7.2	12.8x9.6	17.6x13.2
XF-T0.8X65D	Y	0.8X	65	0.02	0.02	2	11	C-Mount	6x4.5	8x6	11x8.2
XF-T0.8X65	N	0.8X	65	0.02	0.02	2	11	C-Mount	6x4.5	8x6	11x8.2
XF-T1X65D	Y	1X	65	0.025	0.03	1.8	10	C-Mount	4.8x3.6	6.4x4.8	8.8x6.6
XF-T1X65	N	1X	65	0.025	0.03	1.8	10	C-Mount	4.8x3.6	6.4x4.8	8.8x6.6
XF-T2X65D	Y	2X	65	0.02	0.06	0.58	5.5	C-Mount	2.4x1.8	3.2x2.4	4.4x3.3
XF-T2X65	N	2X	65	0.02	0.06	0.58	5.5	C-Mount	2.4x1.8	3.2x2.4	4.4x3.3

Model	Coax.	Mag.	WD (mm)	Telecentricity (degree)	Distortion (%)	DOF (mm)	Resolution (μm)	Mount (17.528mm)	FOV for different Sensor size (mm.x mm)		
									1/3inch 4.8x3.6	1/2inch 6.4x4.8	2/3inch 8.8x6.6
XF-T3X65D	Y	3X	65	0.02	0.02	0.3	5.2	C-Mount	1.6x1.2	2.1x1.6	2.9x2.2
XF-T3X65	N	3X	65	0.02	0.02	0.3	5.2	C-Mount	1.6x1.2	2.1x1.6	2.9x2.2
XF-T4X65D	Y	4X	65	0.02	0.04	0.2	4.2	C-Mount	1.2x0.9	1.6x1.2	2.2x1.65
XF-T4X65	N	4X	65	0.02	0.04	0.2	4.2	C-Mount	1.2x0.9	1.6x1.2	2.2x1.65
XF-T6X65D	Y	6X	65	0.02	0.04	0.12	4	C-Mount	0.8x0.6	1.06x0.8	1.46x1.1
XF-T6X65	N	6X	65	0.02	0.04	0.12	4	C-Mount	0.8x0.6	1.06x0.8	1.46x1.1
XF-T8X65D	Y	8X	65	0.02	0.04	0.09	4.2	C-Mount	0.6x0.45	0.8x0.6	1.1x0.92
XF-T8X65	N	8X	65	0.02	0.04	0.09	4.2	C-Mount	0.6x0.45	0.8x0.6	1.1x0.92

XF-T0.5X65D

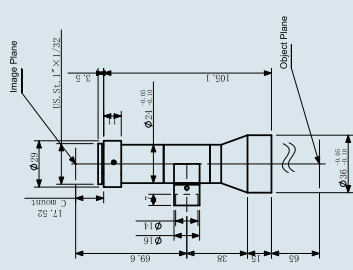

XF-T0.5X65

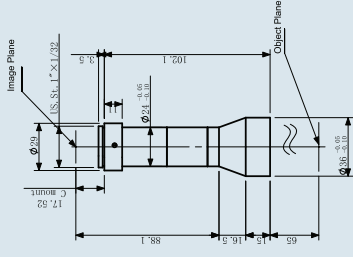

XF-T0.8X65D

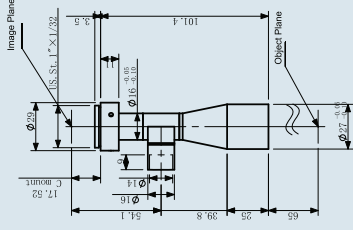

XF-T3X65

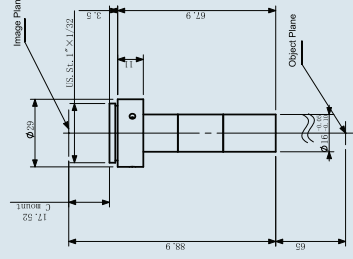

XF-T4X65

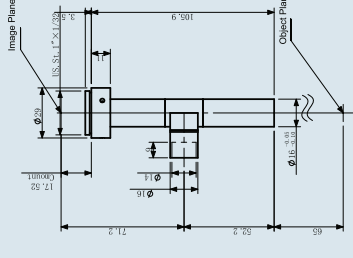

XF-T4X65

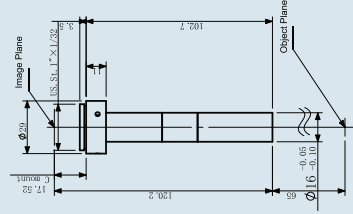

XF-T0.8X65

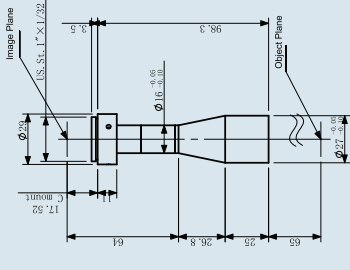

XF-T1X65D

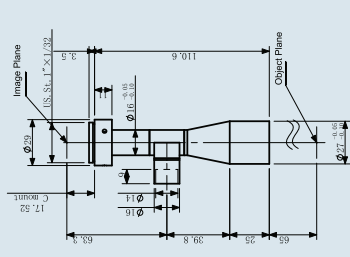

XF-T1X65

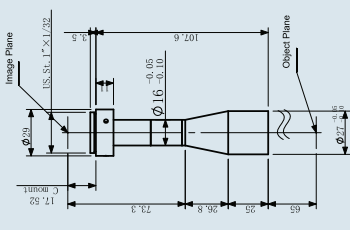

XF-T2X65D

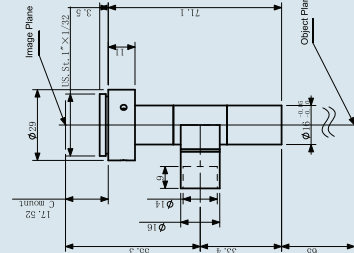

XF-T2X65

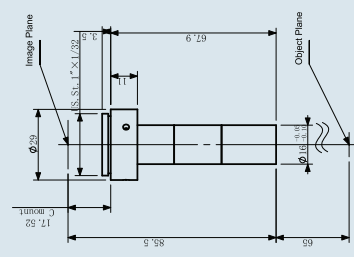

XF-T3X65D

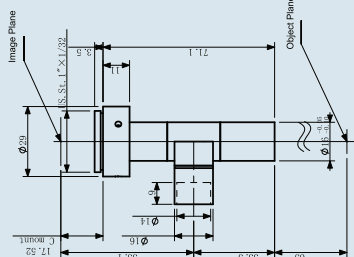

XF-T6X65D

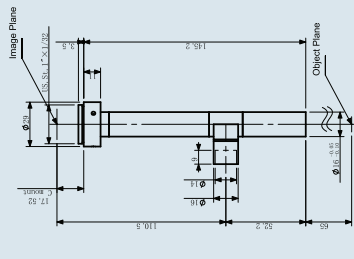

XF-T6X65

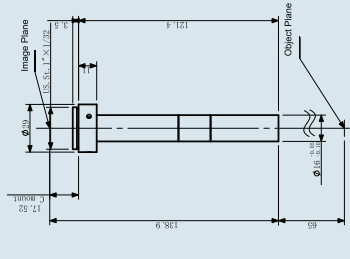

XF-T6X65D

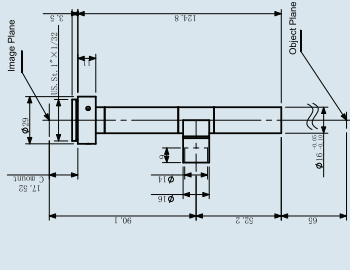

XF-T8X65

